

WZSL CLAMP

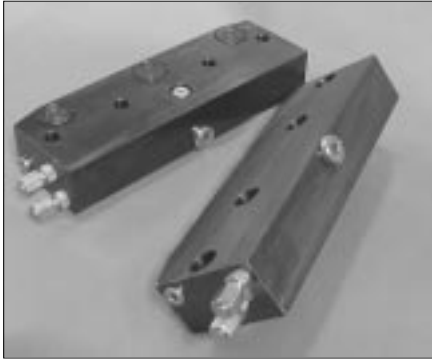

WZSL clamps

Application:

This type of die clamp is used exclusively with dies which have been standardized in die shoe and punch holder sizes, and preferably with die segments not larger than approximately 40" left to right. This restriction in size is mainly due to the fact that the farther the clamps are apart, the more deflection of the die due to stripping forces will occur. To use these clamps with larger dies, additional clamps must be installed in the center of the die, or on the ends, to prevent deflection of the die. The ledge clamps are mounted on top of spacer blocks. The hydraulic pistons in the WZSL clamp act directly onto the clamping edge of the die.

- high power density
- compact design

Note for WZSL-R:

The WZSL-R clamps are equipped with a hydraulically operated check valve, which allows unclamping only if the additional hydraulic circuit is actuated together with releasing the pressure in the clamping circuit. This ensures that even if the clamping circuit loses pressure due to a defect, the check valve in each WZSL-R clamp retains full clamping pressure. Additionally, pressure switches in each clamping circuit will shut down the press immediately if a pressure failure is detected.

Features:

- SAE-ORB porting for reusable, leak proof operation

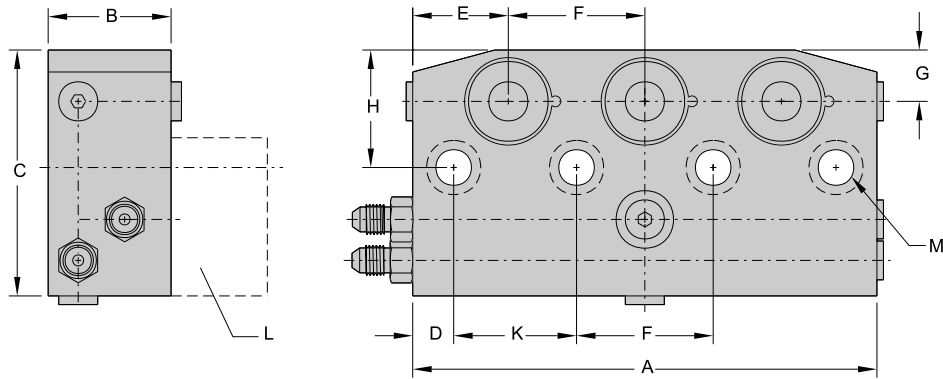

TYPE	Dimensions [in]								Size of bolt 'G'
	'B'	'C'	'D'	'E'	'F'	'G'	'H'	'K'	
WZL25,40,70,100,140	1.75	3.50	.591	1.378	1.969	.74	1.693	1.772	1/2-13
WZL25K	1.75	3.50	.591	1.378	3.936	.74	1.693	2.756	1/2-13

TYPE	Clamping force @3500psi	Total stroke	Check valve	No. of pistons	Lenght 'A'	No. of bolts
UNIT	lbs	in			in	
WZSL25K	13000	.300	NO	3	6.639	4
WZSL25KR	13000	.300	YES	3	6.639	4
WZSL25	13000	.300	NO	3	10.629	4
WZSL25R	13000	.300	YES	3	10.629	4
WZSL40	21600	.300	NO	5	10.629	6
WZSL40R	21600	.300	YES	5	10.625	6
WZSL70	30300	.300	NO	7	14.567	8
WZSL70R	30300	.300	YES	7	14.567	8
WZSL100	43400	.300	NO	10	20.472	11
WZSL100R	43400	.300	YES	10	20.472	11
WZSL140	60900	.300	NO	14	28.346	15
WZSL140R	60900	.300	YES	14	28.346	15



Note:

- Spacer block size 'L' must be adjusted to the standardized clamping height
- All fittings are GFF5X-44